

# Wally Marshall™ SIGNATURE SERIES

## WMR5

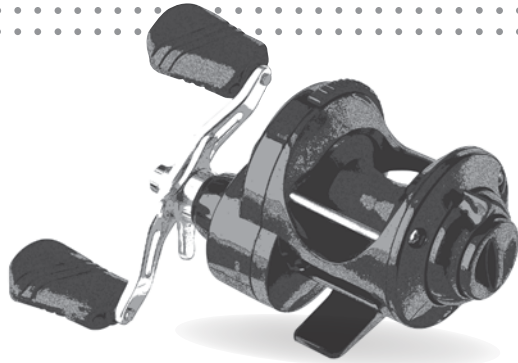

Wally Marshall Signature Series Spinning Reels are designed for  
**tough lightweight performance.**

Wally Marshall™  
SIGNATURE SERIES WMR5

### Reel Specifications

Model	Weight	Ball Bearings	Gear Ratio	Line Capacity
WMR5	5.6 OZ.	2	6.1:1	100/10

#### FEATURES:

- Rigid one-piece graphite frame, spool and side plates
- Two stainless steel ball bearings
- Selective on/off free spool feature
- Precision machined brass gearing
- Selective on/off bait clicker
- Smooth tension adjustment knob
- Gear ratio 6.1:1
- Line capacity 100 yds/10 lb mono
- Prespooled with premium Mr. Crappie Mono

### Maintenance and Care

While applying lubricant to your Wally Marshall™ reel, avoid using multi-purpose oil. Use lightweight silicone based oils or greases made for fishing reels. Apply oil to all bearings, the crank shaft, and the worm gear. Apply grease to the bushings, pinion gears, drive gears, and crank gears. **fig 1**

After usage your reel should be inspected for dirt or sand and cleaned if excessive buildup is present. If your reel has come in contact with saltwater it is important to flush all parts with water, dry and re-lubricate your reel. Through diligent cleaning and maintenance your Wally Marshall™ reel will provide you with years of reliability and sound performance.

For professional cleaning and maintenance send your reel postage prepaid to:

Lew's 3031 N. Martin Ave.  
Springfield, MO 65803  
Phone: 877-470-5397  
FAX: 1-417-881-5387  
lews.com

### One Year Limited Warranty

Wally Marshall™ Warrants its products<sup>1</sup> to withstand normal<sup>2</sup> use for the purpose designed and intended when manufactured for a period of one (1) year from the original retail sale date to the original retail consumer. Wally Marshall™ will at its option repair or replace<sup>3</sup> Wally Marshall™ products when required for the warranty period and return<sup>4</sup> the product to the owner at no additional<sup>5</sup> cost to the owner.

<sup>1</sup>Numerous products have been manufactured under variations of the Wally Marshall™ name and under the Wally Marshall™ Logo by multiple businesses over the past 50 years. This warranty is specifically for products manufactured on behalf of Wally Marshall™ of Springfield, Missouri USA since March 1, 2011. Wally Marshall™ products manufactured by or on behalf of other entities prior to March 1, 2011 are not covered by this warranty. In all circumstances, this Warranty is Limited in Value to the original retail value of the product and is limited to actual damage to the Wally Marshall™ product and only the Wally Marshall™ product. <sup>2</sup>Loss of a product, and loss/damage of a product or parts due to the attempted repair or servicing of a Wally Marshall™ product by any person or business other than Wally Marshall™ or Wally Marshall™ Authorized Warranty Service Agent, and damage caused by or resulting from abuse, misuse, lack of recommended maintenance, accident, acts of God, and shipping damages occurring in transit to Wally Marshall™ or Wally Marshall™ Authorized Agent are outside the scope of Wally Marshall™ Limited Warranty and will be repaired through Wally Marshall™ after warranty services at the expense of the consumer. <sup>3</sup>Any products replaced by Wally Marshall™ will be new or remanufactured by a Wally Marshall™ Authorized Agent with the same or next model upgrade product. <sup>4</sup>Wally Marshall™ will return warranted products to the consumer by reasonable means as determined by Wally Marshall™. <sup>5</sup>Express or expedited services are the responsibility of the consumer as is sending the product to Wally Marshall™ or Wally Marshall™ Authorized Agent, for Warranty Service. Wally Marshall™ and Wally Marshall™ Service Agents as authorized by Wally Marshall™ are the sole agents authorized to repair or replace Wally Marshall™ products under the terms of this warranty. Only written changes by an officer of Wally Marshall™ can alter the terms or conditions of this warranty.

This warranty gives you specific legal rights including additional rights extended by some states which do not allow certain exclusions and limitations. Any action brought against Wally Marshall™ for the purpose of settling a warranty dispute shall be brought and litigated in the State of Missouri, County of Greene.

# Wally Marshall™ SIGNATURE SERIES WMR5

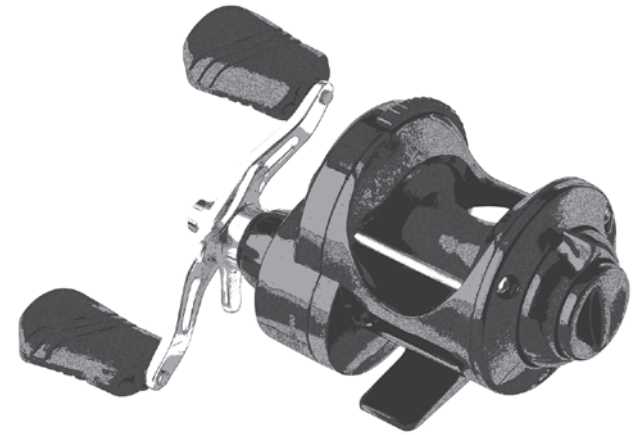
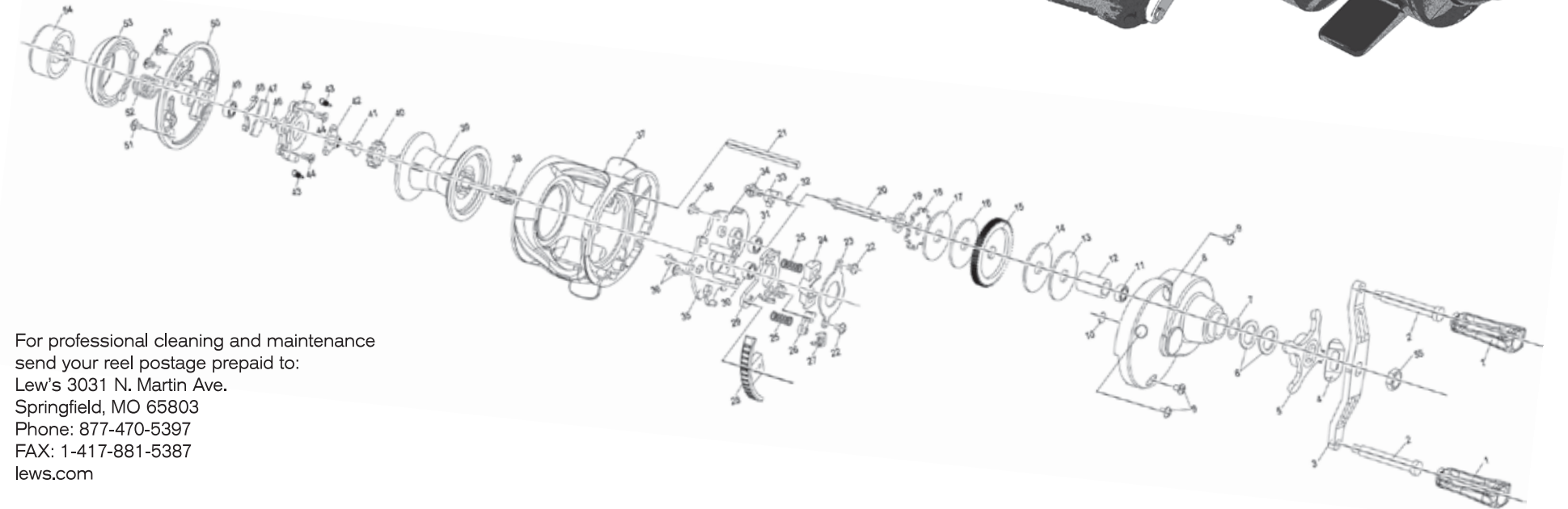

fig 1 To remove side cover unscrew side-plate screws pry front cover away from body to access components



For professional cleaning and maintenance  
send your reel postage prepaid to:  
Lew's 3031 N. Martin Ave.  
Springfield, MO 65803  
Phone: 877-470-5397  
FAX: 1-417-881-5387  
lews.com

KEY NO.	PARTS NAME	KEY NO.	PARTS NAME	KEY NO.	PARTS NAME	KEY NO.	PARTS NAME	KEY NO.	PARTS NAME	KEY NO.	PARTS NAME
1	HANDLE KNOB	11	BALL BEARING	21	LINE RETAINING SHAFT	31	BALL BEARING	41	PAWL PIN	51	SCREW
2	HANDLE RIVET	12	MAIN GEAR BUSHING	22	SCREW	32	E-RING	42	PAWL PLATE	52	SPRING
3	CRANK	13	DRAG WASHER	23	CLUTCH RETAINER PLATE	33	RETAINER PLATE	43	SPRING	53	DRIVE PLATE
4	FRICTION WASHER	14	FRICTION WASHER	24	CLUTCH BAR	34	RETAINER PIN	44	SCREW	54	HANDLE CAP
5	STAR DRAG	15	DRIVE GEAR	25	CLUTCH SPRING	35	HOLDER PLATE	45	PAWL RETAINER	55	NUT
6	DRAG SPRING WASHER	16	FRICTION WASHER	26	KICK LEVER	36	SCREW	46	SCREW		
7	WASHER	17	DRAG WASHER	27	SPRING	37	FRAME	47	PLATE		
8	RIGHT SIDE PLATE	18	RATCHET	28	CLUTCH HANDLE	38	PINION GEAR	48	PAWL SLICE		
9	SCREW	19	ANTI-REVERSE PAWL	29	CLUTCH CAM	39	SPOOL	49	BALL BEARING		
10	WASHER	20	GEAR SHAFT	30	BALL BEARING	40	PAWL	50	LEFT SIDE PLATE		